



www.genswiss.com
sales@genswiss.com
1-413-562-4800

multidec® **Swiss-Type Tools**

Coolant Thru Wedges & Accessories

UTILIS®

Tooling for High Technology

Adjustable Graduated Stop
For Quick Change

Coolant Connection Ports (M5x0.8)

Gang Plate Position Stop

Coolant Jets

- Works With Any High-Quality Square Shank Tooling
- Adjustable Stop Provides Quick Change Capability
- Eliminates Stringy Chips From Collecting On Your Cutting Tools
- Low Interference Design

Coolant Spray Patterns

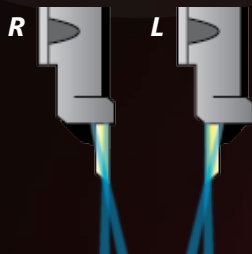

Right Hand Coolant
Jets w/ Right Hand
Tool Shank

Left Hand Coolant
Jets w/ Left Hand
Tool Shank

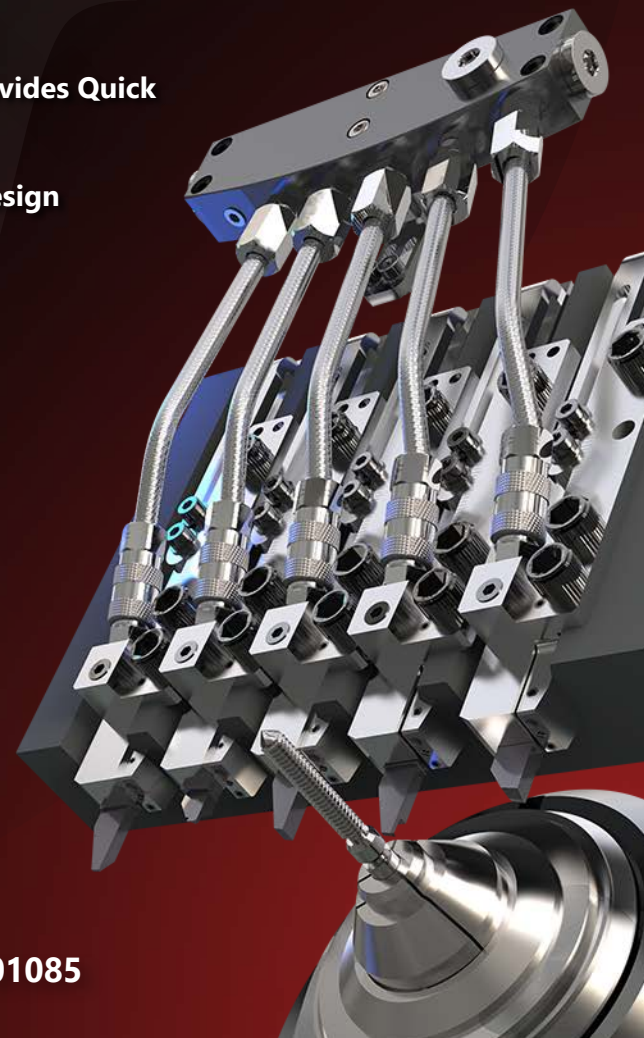

www.genswiss.com | 1-(413)-562-4800

sales@genswiss.com | 6 Old Stage Road, Westfield, MA 01085

Coolant Accessories For True Coolant Flexibility

Compact Accessories With High Pressure Capability



Tight Bending Radius



Coolant Input Using Optional 1/4" JIC to 1/8 BSPF Fitting

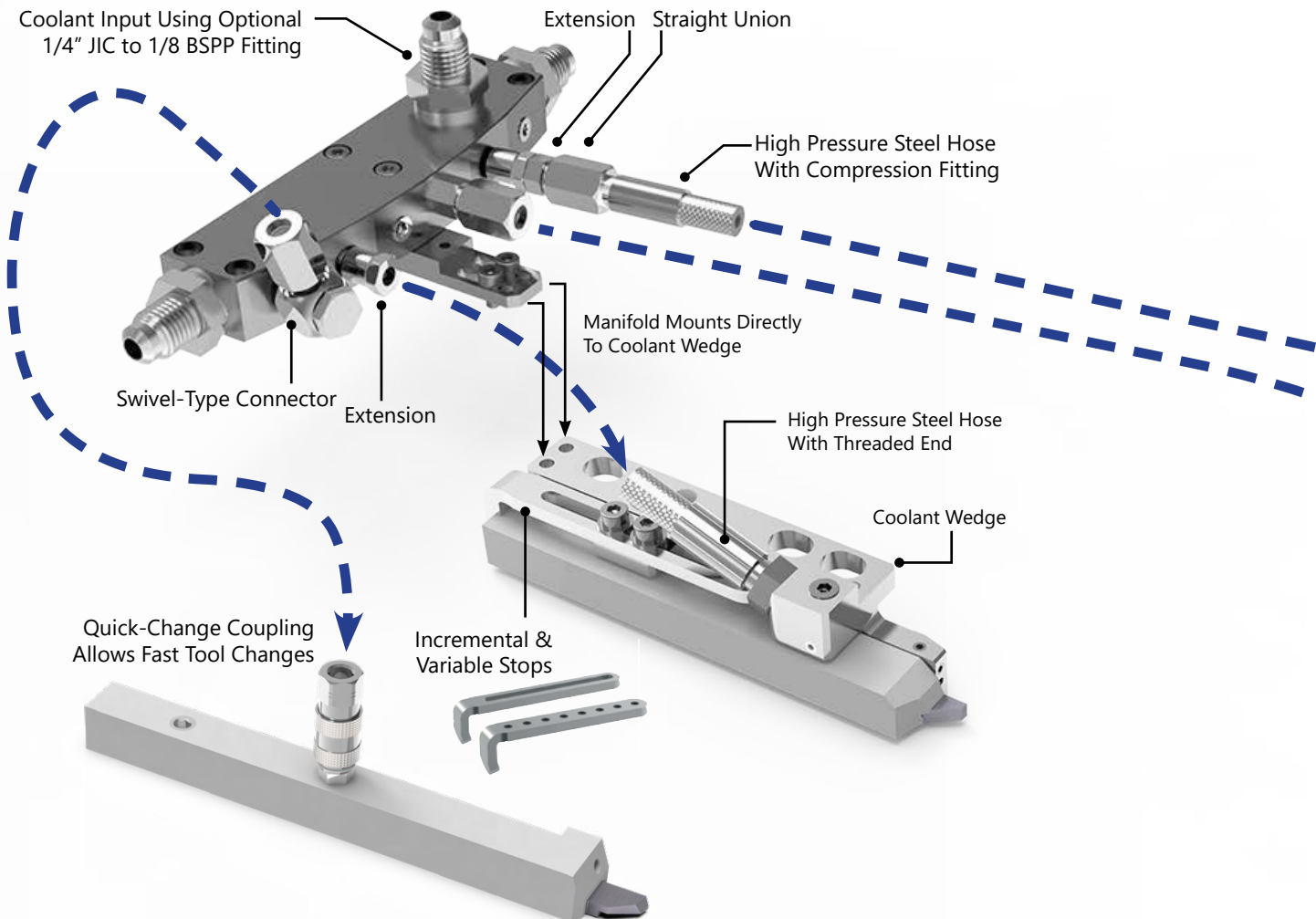

Many Connection Combinations Available...

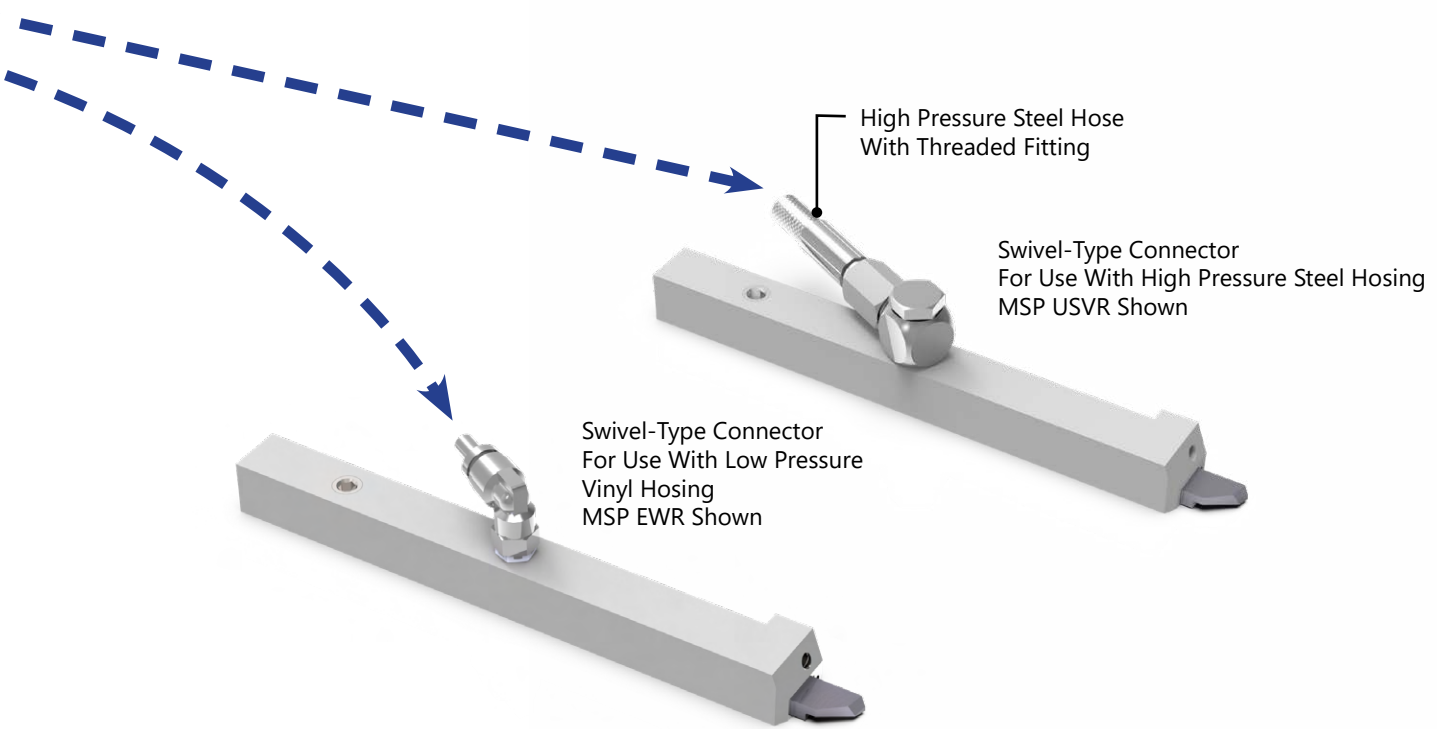
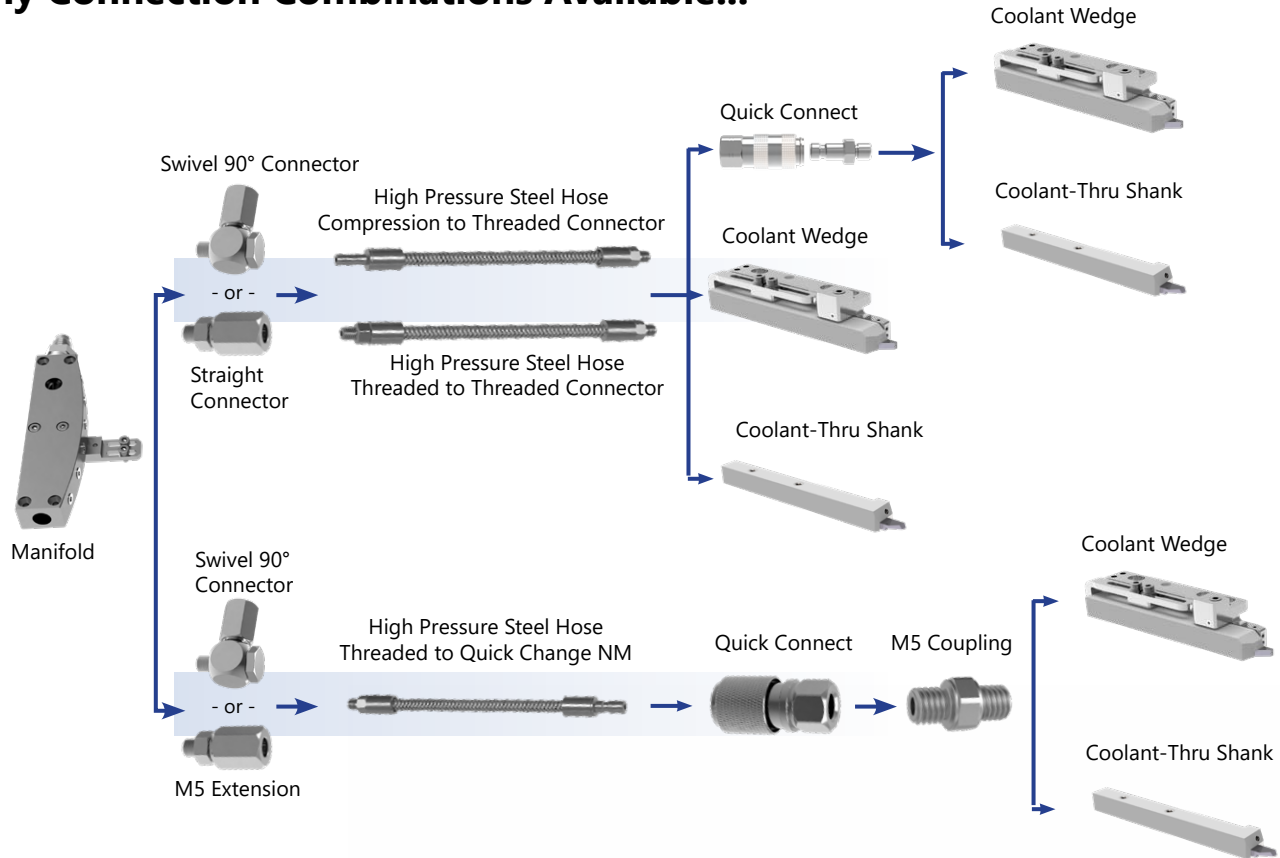

**Need Low-Pressure Hoses & Fittings?
Contact GenSwiss**

Citizen - Coolant Thru Clamps

Machine Model	Holder	Tool Plate	Pos.	Left Hand		Right Hand	
				Item No.	Description	Item No.	Description
R07	8x8mm	QFT4308	T11-T12	Call For Details	MLU CI-12 R-L IC-F	Call For Details	MLU CI-12 R-R IC-F
L12	8x8mm	GTF7020	T1-T6	Call For Details	MLU CI-10 R-L IC-F	Call For Details	MLU CI-10 R-R IC-F
L12	3/8in (9.525mm)	GTF7010L	T1-T6	7005-117158	MLU CI-07 R-L IC-F	7005-117136	MLU CI-07 R-R IC-F
C16, K12, K16, M16	10x10mm	GTF6010, BTF1010, GTF5110, (5J003 M)	T1-T6	7005-117049	MLU CI-02 R-L IC-F	7005-117048	MLU CI-02 R-R IC-F
K12, L12	10x10mm	GTF7010	T1-T6	7005-117157	MLU CI-09 R-L IC-F	7005-117156	MLU CI-09 R-R IC-F
L16	10x10mm	GTF3110	T1-T4	Call For Details	MLU CI-14 R-L IC-F	Call For Details	MLU CI-14 R-R IC-F
A20, K12, K16, L20, M16	12x12mm	BTF1012, GTF3812	T1-T6	7005-117047	MLU CI-01 R-L IC-F	7005-117037	MLU CI-01 R-R IC-F
A20, L20	12x12mm	GTF3612, BTF2212, BTF2412	T2-T5	7005-117047	MLU CI-01 R-L IC-F	7005-117037	MLU CI-01 R-R IC-F
A20, M20	12x12mm	BTF2413, GTF2513	T1-T6	7005-117122	MLU CI-05 R-L IC-F	7005-117121	MLU CI-05 R-R IC-F
A20, L20	1/2in (12.7mm)	BTF2213, BTF2413, GTF3113	T2-T6	7005-117082	MLU CI-03 R-L IC-F	7005-117081	MLU CI-03 R-R IC-F
A232, M32	16x16mm, 5/8in	GTF5216, GTF5816	T1-T5	7005-117135	MLU CI-08 R-L IC-F	7005-117137	MLU CI-08 R-R IC-F
L25, L32	16x16mm, 5/8in	GTF4016, GTF4516	T11-T15	7005-117135	MLU CI-08 R-L IC-F	7005-117137	MLU CI-08 R-R IC-F
L20	16x16mm, 5/8in	BTF2413, GTF3612	T1 (Cut Off)	7005-117135	MLU CI-08 R-L IC-F	7005-117137	MLU CI-08 R-R IC-F

STAR - Coolant Thru Clamps

Machine Model	Holder	Tool Plate	Pos.	Left Hand		Right Hand	
				Item No.	Description	Item No.	Description
SR-10J	8x8mm	691-01	T1-T6	7005-117056	MLU ST-01 R-L IC-F	7005-117055	MLU ST-01 R-R IC-F
SR-16R, SR-20R, RII	12x12mm	541-01	T1-T6	7005-150451	MLU ST-07 R-L IC-F	7005-150448	MLU ST-07 R-R IC-F
SR-20J, RIII, RIV, SB-16	12x12mm	0E0-62, 680-62, 0W0-62, 481-02	T2-T6	7005-150451	MLU ST-07 R-L IC-F	7005-150448	MLU ST-07 R-R IC-F
SR-20J, RIII, SB-16	12x12mm	0E0-62, 680-62, 481-02	T1 (Cut Off)	7005-150452	MLU ST-08 R-L IC-F	7005-150449	MLU ST-08 R-R IC-F
SR-20RIV	12x12mm	0W0-62	T1 (Cut Off)	7005-150450	MLU ST-09 R-L IC-F	7005-150447	MLU ST-09 R-R IC-F
SV-12, 20	12x12mm	421-01	T3-T5	Call For Details	MLU ST-10 R-L IC-F	7005-150268	MLU ST-10 R-R IC-F
SV-12, 20	12x12mm	421-01	T1 (Cut Off), T2	7005-150272	MLU ST-11 R-L IC-F	7005-150269	MLU ST-11 R-R IC-F
SV-12, 20	1/2in (12.7mm)	421-91	T3-T5	Call For Details	MLU ST-05 R-L IC-F	7005-117148	MLU ST-05 R-R IC-F
SR-32J	16x16mm, 5/8in	670-62	T2-T6	7005-150287	MLU ST-03 R-L IC-F	7005-150286	MLU ST-03 R-R IC-F
SR-32J	16x16mm, 5/8in	670-62	T1 (Cut Off)	7005-117172	MLU ST-02 R-L IC-F	7005-117171	MLU ST-02 R-R IC-F
SV-32	16x16mm	421-04	T2-T4	Call For Details	MLU ST-13 R-L IC-F	7005-150292	MLU ST-13 R-R IC-F
SV-32	16x16mm	421-04	T1 (Cut Off)	7005-150289	MLU ST-12 R-L IC-F	7005-150288	MLU ST-12 R-R IC-F

Tsugami - Coolant Thru Clamps

Machine Model	Holder	Tool Plate	Pos.	Left Hand		Right Hand	
				Item No.	Description	Item No.	Description
BH, BO, BS, S	12x12mm		T1-T8, T18-T24	7005-117161	MLU TS-02 R-L IC-F	7005-117130	MLU TS-02 R-R IC-F
H207, SS207, SS207-SAX	12x12mm		T1-T8, T18-T21	Call For Details	MLU TS-01 R-L IC-F	7005-117127	MLU TS-01 R-R IC-F
BH20	12x12mm		T1 (Cut Off)	7005-117168	MLU TS-04 R-L IC-F	7005-117167	MLU TS-04 R-R IC-F
HS237	16x16mm		T1-T5	Call For Details	MLU TS-06 R-L IC-F	Call For Details	MLU TS-06 R-R IC-F

Tornos - Coolant Thru Clamps

Machine Model	Holder	Tool Plate	Pos.	Left Hand		Right Hand	
				Item No.	Description	Item No.	Description
GT13, DT13	12x12mm	390224, 390223	T1-T5	7005-XXXXXX	MLU TO-06 R-L IC-F	Call For Details	MLU TO-06 R-R IC-F
GT13, DT13	12x12mm	390224	T1 (Cut Off)	7005-XXXXXX	MLU TO-07 R-L IC-F	Call For Details	MLU TO-07 R-R IC-F
CT20/5	12x12mm	2000118	T1-T6	7005-XXXXXX	MLU TO-05 R-L IC-F	Call For Details	MLU TO-05 R-R IC-F
SWISS GT26	16x16mm	386209	T1-T5	7005-XXXXXX	MLU TO-04 R-L IC-F	7005-150807	MLU TO-04 R-R IC-F
SWISS GT26	16x16mm	386210	T2-T4	7005-XXXXXX	MLU TO-03 R-L IC-F	7005-150808	MLU TO-03 R-R IC-F
SWISS GT26	16x16mm	386210	T1, T2 (Cut Off)	7005-XXXXXX	MLU TO-02 R-L IC-F	7005-150806	MLU TO-02 R-R IC-F

Hanwha - Coolant Thru Clamps

Machine Model	Holder	Tool Plate	Pos.	Left Hand		Right Hand	
				Item No.	Description	Item No.	Description
XD12 J, SL16 S	12x12mm		T1-T6	7005-117113	MLU HA-01 R-L IC-F	7005-117112	MLU HA-01 R-R IC-F
XD20 H, XD20 J, SL200	12x12mm		T1-T6	Call For Details	MLU HA-02 R-L IC-F	7005-117154	MLU HA-02 R-R IC-F

Need Help Choosing A Coolant Wedge? See Last Page

Manifolds

High Pressure

Item No.	Description	G	B	d	L	Inputs (G)	Outputs (d)
7005-117164	MLU KV 2-2 S	G1/8	24mm	M5	23mm	2	2
7005-117163	MLU KV 4-3 S	G1/8	24mm	M5	45mm	3	4
7005-117149	MLU KV 6-3 S	G1/8	24mm	M5	65mm	3	6
7005-117160	MLU KV 8-3 S	G1/8	25mm	M5	85mm	3	8
Call For Details	MLU KV 2-2 L	G1/8	25mm	M5	35mm	2	2
Call For Details	MLU KV 4-3 L	G1/8	25mm	M5	68mm	3	4
Call For Details	MLU KV 6-3 L	G1/8	28mm	M5	105mm	3	6
Call For Details	MLU KV 8-3 L	G1/8	25mm	M5	138mm	3	8

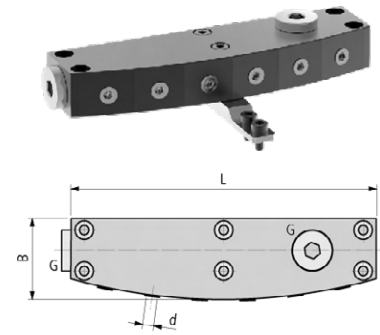

Manifold Fitting: Input

High Pressure

Item No.	Description	Manifold Pos.
4005-000104	Straight 0° 1/4" JIC to 1/8 BSPP	Input
4005-000105	Straight 45° 1/4" JIC to 1/8 BSPP	Input
4005-000106	Straight 90° 1/4" JIC to 1/8 BSPP	Input



Straight Union

High Pressure

Item No.	Description	g	d	L	Coolant Manifold
7005-150082	MSP UGVR M5-4	M5	4mm	27mm	MLU KV...L
7005-146214	MSP UGVR G1/8-4	G1/8	4mm	32mm	MLU KV...L
Call For Details	MSP UGVR PT1/8	PT1/8	4mm	32mm	MLU KV...L

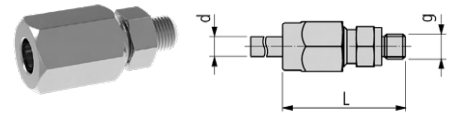

Swivel Union

High Pressure

Item No.	Description	g	d	L	C	Coolant Manifold
7005-150086	MSP USVR M5-4	M5	4mm	28mm	21mm	MLU KV...L
7005-146218	MSP USVR G1/8-4	G1/8	4mm	37mm	30mm	MLU KV...L
Call For Details	MSP USVR M5-M5	M5	M5	19mm	16mm	MLU KV...L

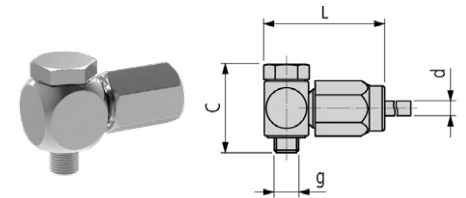

Extension

High Pressure

Item No.	Description	G	g	L
Call For Details	MSP VL 100 M5-M5	M5	M5	10mm
Call For Details	MSP VL 200 M5-M5	M5	M5	20mm
Call For Details	MSP VL 400 M5-M5	M5	M5	40mm

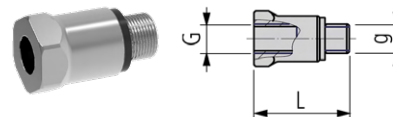

Quick Change Connection 90° Swivel High Pressure

Item No.	Description	g	L	C
Call For Details	MSP USNM M5	M5	22mm	16mm

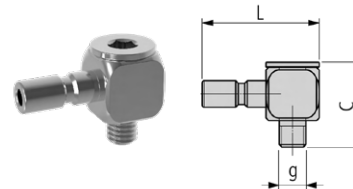

Quick Change Connection 90° High Pressure

High Pressure

Item No.	Description	g	L	C
Call For Details	MSP UANM M5	M5	21mm	10mm

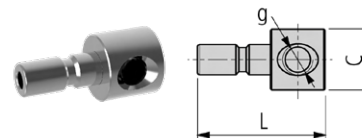

Quick-Change Connection (Plug)

Item No.	Description	g	L
7005-150091	MSP UNM M5	M5	21mm

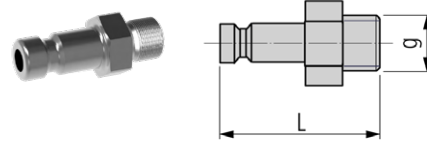

Quick-Change Connection M5 (Coupling)

Item No.	Description	g	L
Call For Details	MSP UCF M5	M5	21mm

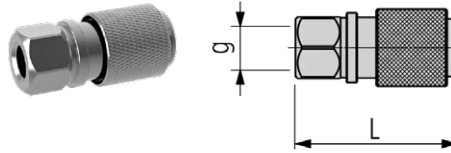

Quick-Change Connection PT (Coupling)

Item No.	Description	g	L
Call For Details	MSP UCF PT1/8	PT1/8	20mm

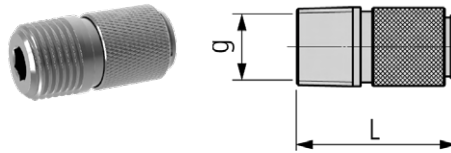

Quick-Change Connection PT (Coupling)

Item No.	Description	g	L
Call For Details	MSP UACF M5	M5	20mm

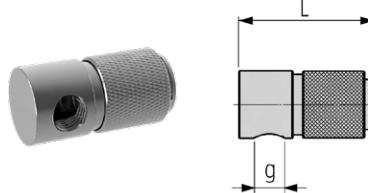

Coolant Fitting Reduction Union

M5 Male

Item No.	Description	G	g	L
7005-117065	MSP RVR 100 M5-M6	M6	M5	15mm
7005-117066	MSP RVR 185 M5-M8x1	M8x1	M5	23mm
7005-117067	MSP RVR 225 M5-M10x1	M10x1	M5	27mm
7005-117068	MSP RVR 225 M5-G1/8"	G1/8"	M5	27mm

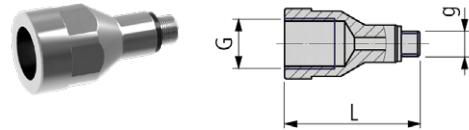

Coolant Fitting Reduction Union

M5 Female

Item No.	Description	G	g	L
7005-117143	MSP RVR 100 M6-M5	M5	M6	18mm
7005-117144	MSP RVR 70 M8x1-M5	M5	M8x1	15mm
7005-117145	MSP RVR 70 M10x1-M5	M5	M10x1	15mm
7005-117146	MSP RVR 70 G1/8"-M5	M5	G1/8"	15mm

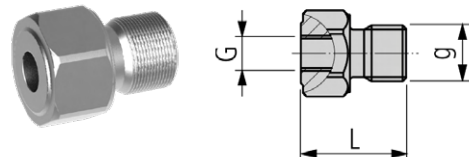

M5 Coupling

Item No.	Description	g	L	C
Call For Details	MSP EVRA M5-M5	M5	12mm	M5

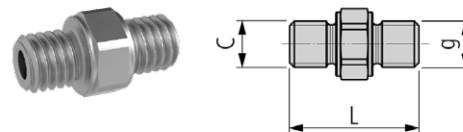

M5 Coupling

Item No.	Description	g	L	C
Call For Details	MSP EVRI M5-M5	M5	14mm	M5

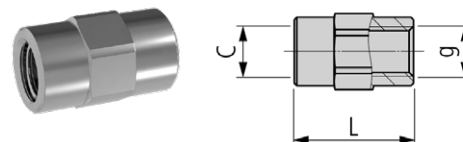

Conversion Fittings:

Item No.	Description
4005-000111	0° Male Union - M5-0.8 to 1/4 JIC Flare Fitting. Connects to side ports on all shank sizes. Included With All Coolant-Thru Shanks



Screw Plugs

Item No.	Description	g	L
7005-146222	MSP VSR G1/8 IB5	G1/8	11mm
Call For Details	MSP VSR M5 IB2.5	M5	4mm
Call For Details	MSP VSR M8x1 IB4	M8x1	5.5

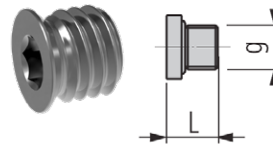

High Pressure Steel Braided Hosing

Compression to Threaded M5

Item No.	Description	L	C	U	I
Call For Details	MSP UHPT 100 M5-4	100	4	M5	3.0
7005-154443	MSP UHPT 150 M5-4	150	4	M5	3.0
7005-150110	MSP UHPT 200 M5-4	200	4	M5	3.0
Call For Details	MSP UHPT 250 M5-4	250	4	M5	3.0
7005-150111	MSP UHPT 300 M5-4	300	4	M5	3.0
Call For Details	MSP UHPT 400 M5-4	400	4	M5	3.0
7005-150113	MSP UHPT 500 M5-4	500	4	M5	3.0
Call For Details	MSP UHPTB 100 M5-4	100	4	M5	3.7
Call For Details	MSP UHPTB 150 M5-4	150	4	M5	3.7
Call For Details	MSP UHPTB 200 M5-4	200	4	M5	3.7
Call For Details	MSP UHPTB 250 M5-4	250	4	M5	3.7
Call For Details	MSP UHPTB 300 M5-4	300	4	M5	3.7
Call For Details	MSP UHPTB 400 M5-4	400	4	M5	3.7
Call For Details	MSP UHPTB 500 M5-4	500	4	M5	3.7

Units of Measurement = mm

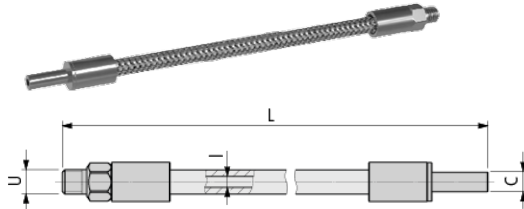

Quick Connect NM Connector to Threaded M5

Item No.	Description	L	C	U	I
Call For Details	MSP UHPT 100 NM-M5	100	NM	M5	3.0
Call For Details	MSP UHPT 150 NM-M5	150	NM	M5	3.0
Call For Details	MSP UHPT 200 NM-M5	200	NM	M5	3.0
Call For Details	MSP UHPT 250 NM-M5	250	NM	M5	3.0
Call For Details	MSP UHPT 300 NM-M5	300	NM	M5	3.0
Call For Details	MSP UHPT 400 NM-M5	400	NM	M5	3.0
Call For Details	MSP UHPT 500 NM-M5	500	NM	M5	3.0
Call For Details	MSP UHPTB 100 NM-M5	100	NM	M5	3.7
Call For Details	MSP UHPTB 150 NM-M5	150	NM	M5	3.7
Call For Details	MSP UHPTB 200 NM-M5	200	NM	M5	3.7
Call For Details	MSP UHPTB 250 NM-M5	250	NM	M5	3.7
Call For Details	MSP UHPTB 300 NM-M5	300	NM	M5	3.7
Call For Details	MSP UHPTB 400 NM-M5	400	NM	M5	3.7
Call For Details	MSP UHPTB 500 NM-M5	500	NM	M5	3.7

Units of Measurement = mm

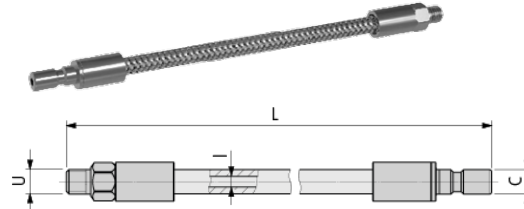

Threaded M5 to Threaded M5

Item No.	Description	L	C	U	I
Call For Details	MSP UHPT 100 M5-M5	100	M5	M5	3
Call For Details	MSP UHPT 150 M5-M5	150	M5	M5	3
Call For Details	MSP UHPT 250 M5-M5	250	M5	M5	3
Call For Details	MSP UHPT 300 M5-M5	300	M5	M5	3
Call For Details	MSP UHPT 400 M5-M5	400	M5	M5	3
Call For Details	MSP UHPT 500 M5-M5	500	M5	M5	3
Call For Details	MSP UHPTB 100 M5-M5	100	M5	M5	3.7
Call For Details	MSP UHPTB 150 M5-M5	150	M5	M5	3.7
Call For Details	MSP UHPTB 200 M5-M5	200	M5	M5	3.7
Call For Details	MSP UHPTB 250 M5-M5	250	M5	M5	3.7
Call For Details	MSP UHPTB 300 M5-M5	300	M5	M5	3.7
Call For Details	MSP UHPTB 400 M5-M5	400	M5	M5	3.7
Call For Details	MSP UHPTB 500 M5-M5	500	M5	M5	3.7

Units of Measurement = mm

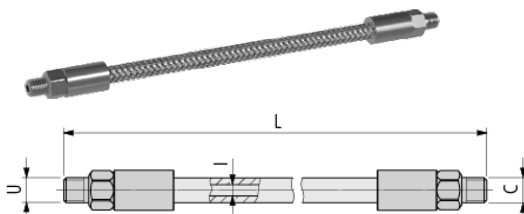

If you need assistance choosing a clamp, GenSwiss will help! Before contacting GenSwiss, obtain the exact dimensions of the tool plate and clamping shim (see the diagrams below) and enter each into the provided tables. Be sure to take measurements from the tool plate position where the multidec® quick-change clamping shims will be used.

Machine Info	
Manufacturer	
Type	
Year Manufactured	
Serial Number	
Plate Number	
Shaft Cross-Section	

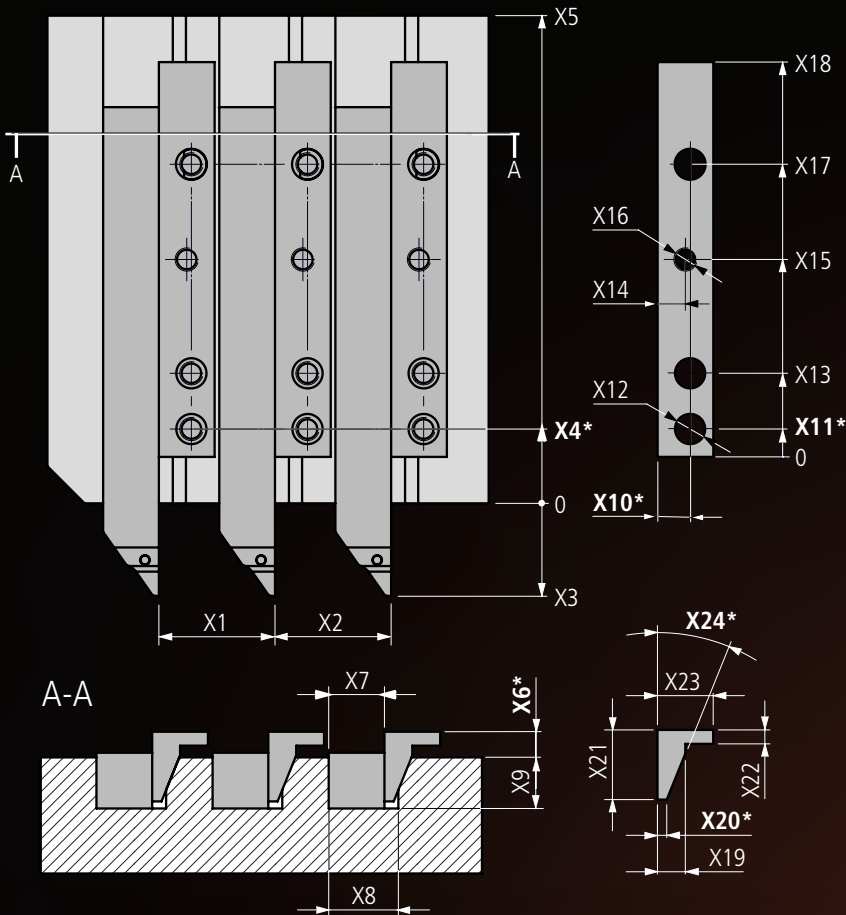

Dimensions	(in)
X1	
X2	
X3	
X4*	
X5	
X6*	
X7	
X8	
X9	
X10*	
X11*	
X12	

Dimensions	(in)
X13	
X14	
X15	
X16	
X17	
X18	
X19	
X20*	
X21	
X22	
X23	
X24*	

*Critical Dimensions

1600 & 3000 Series Inserts & Holders...

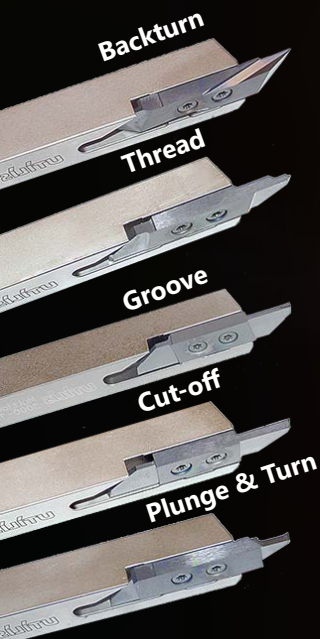

Use of both cutting edges is guaranteed as cutting edges are not used for location of insert.

Holder features force absorbing insert pocket design.

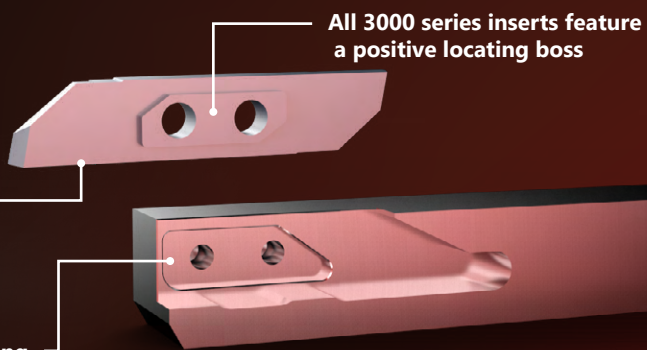

Call Us Today!
(413)562-4800

